

## Benefits

- Ideal for smart buildings; integrate with building and home automation systems.
- CDi2 EasyDrive is certified for Smoke & Heat Extraction (SHE).

## Applications

Concealed automated operation of awning windows, hopper windows, casement windows, curtain wall vents, and skylights.



## CDi2 Actuator Features

- CDi2 EasyDrive actuators are medium duty operators, with compact casing and low noise operation.
- Push force: Up to 300N (67 lbf)
- Pull force: 300N (67 lbf)
- Actuator has stainless steel chain for rigidity and durability; Chain is off-center in casing.
- Can be concealed in frame or curtain wall
- Integrated cycle counter automatically keeps count of open-closed cycles during life of actuator
- Actuators available in Black color
- Prewired with 3.1 meter cable
- Tested to 10,000 cycles

## Pre-Programmed EasyDrive Features

Using one communication line, EasyDrive can program up to 8 single actuators on separate vents or synchronize multiple actuators on one vent.

### Programming must be specified at order

<b>Chain stroke</b>	From 21mm up to 800mm (varies by model).
<b>Speed adjustment</b>	Programmable from 10mm/sec down to 4mm/sec for quiet operation.
<b>Speed reduction</b>	For the last seconds of closing, as a safety precaution.
<b>Seal relief adjustment</b>	Between 0-20mm to protect sash at closed position.
<b>Feedback Signal</b>	OPEN or CLOSE can be selected

## CDi2 EasyDrive

Part #	Color	Stroke	Force (Push/Pull)
<b>13336024500</b>	Black	Up to 500mm	300N/300N
<b>13336024600</b>	Black	Up to 600mm	300N/300N
<b>13336024800</b>	Black	Up to 800mm	300N/300N

## Tandem Capability

### Must be specified at order

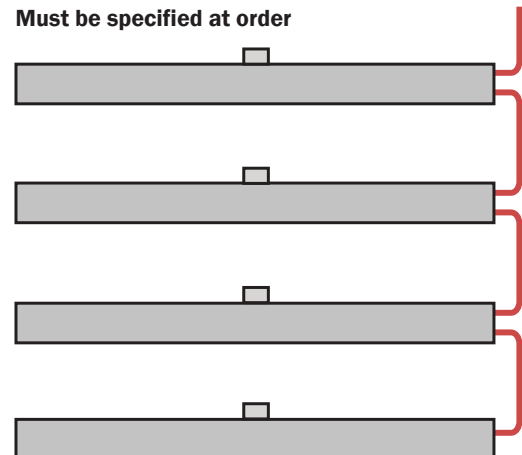

## Specifications

<b>Supply voltage</b>	24VDC (-15% / +50%)
<b>Nom. Current draw</b>	Approx 0.9A at 300N load
<b>Limit stop</b>	(Open): Built in limit switch (Closed) Integrated electronic power cut-off
<b>Chain stroke (approx)</b>	21 to 500mm ( $13\frac{1}{16}$ " to $19\frac{3}{4}$ "), adjustable 21 to 600mm ( $13\frac{1}{16}$ " to $23\frac{5}{8}$ "), adjustable 21 to 800mm ( $13\frac{1}{16}$ " to $31\frac{1}{2}$ "), adjustable
<b>Chain adjustment</b>	Automatic adjustment
<b>Push force (Max)</b>	Up to 300N (67 lbf +/- 3%), adjustable
<b>Pull force (Max)</b>	300N (67 lbf +/- 3%), adjustable
<b>Clamping force (Max)</b>	3000N (899 lbf +/- 3%) force needed to rip chain out of actuator case
<b>Chain speed</b>	4-15mm/sec
<b>Dimensions</b>	21-511mm stroke = 820 x 40 x 40mm ( $32\frac{5}{16}$ " x $1\frac{5}{8}$ " x $1\frac{5}{8}$ ") 21-603mm stroke = 1011 x 40 x 40mm ( $39\frac{13}{16}$ " x $1\frac{5}{8}$ " x $1\frac{5}{8}$ ") 21-810mm stroke = 1011 x 40 x 40mm ( $39\frac{13}{16}$ " x $1\frac{5}{8}$ " x $1\frac{5}{8}$ ")
<b>Power cable</b>	3.1 meter cable included, black color
<b>Run/Rest cycle</b>	For every 60 sec running (on), must then rest (off) for 120 sec
<b>Ambient Oper Temp</b>	-10 °C to +60 °C (14 °F to 140 °F)
<b>Listing</b>	UR Recognized
<b>Protection class</b>	IP20
<b>Case</b>	Aluminum
<b>Opening mechanism</b>	Stainless steel chain, chain is off-centered in case

## Dimensions

500mm stroke	600mm stroke	800mm stroke
Length X = 590mm	Length X = 640mm	Length X = 740mm
Length Y = 253mm	Length Y = 253mm	Length Y = 253mm

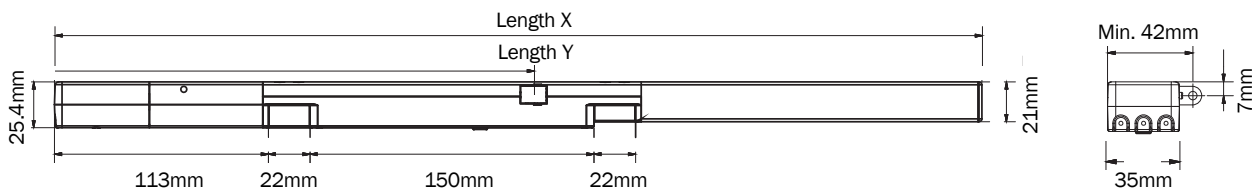

**Discuss with AFI Sales & Support for your specific project/profile.**