

CRM Control Panel and Weather Detection System

CRM3 for DC actuators, part # 40821J
CRM4 for AC actuators, part # 40822K

CRM3 and CRM4 Applications

- CRM includes a control relay box and a power supply; additional relay box or power supply is not needed, unless use exceeds CRM capacity (4 amp for CRM3 for DC actuators; 7 amps for CRM4 for AC actuators).
- Use CRM to add **Remote Control** option to actuator(s), see page 2.
- Use CRM to add **Weather Sensor** option(s) to actuators, see page 2.

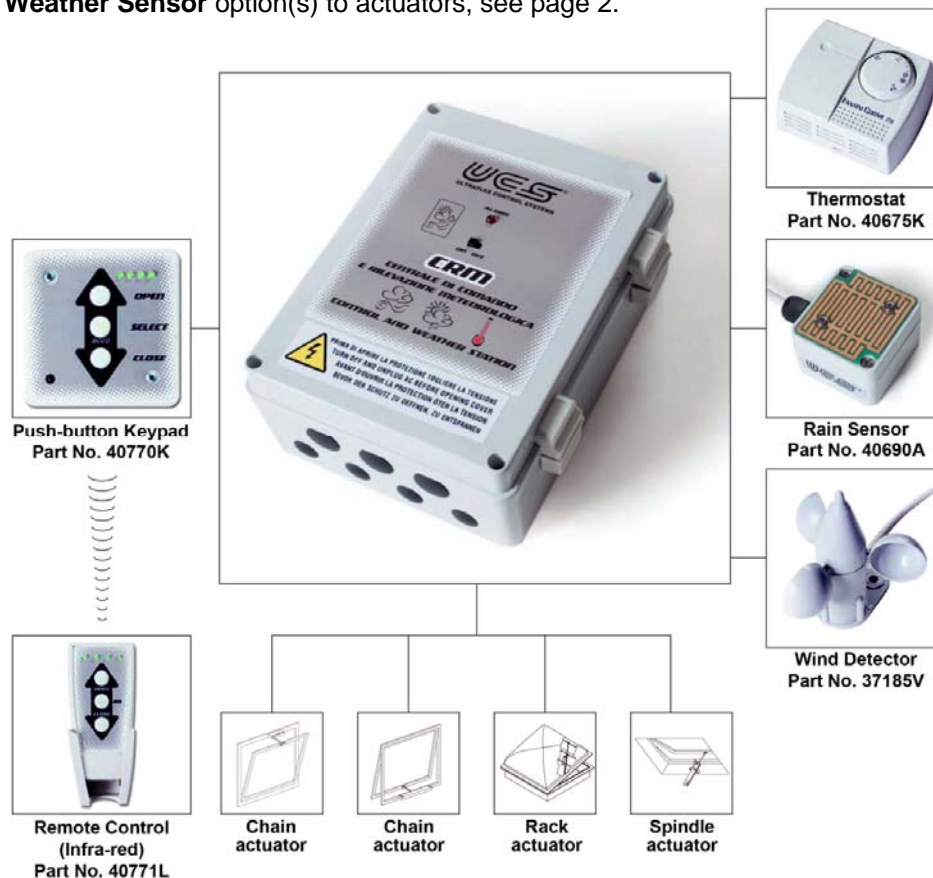

CRM Features

- CRM control panel provides control of 1 to 4 actuator groups via the keypad, remote, and/or weather sensors.
- Closes the windows in case of conditions detected by its weather sensors.
- Optional weather sensors can be disabled via its front panel ON/OFF switch.
- Control an unlimited number of Relay Boxes to power multiple low voltage actuators.
- Can be controlled by an external control system via its 3-wire, momentary contact switch terminals.
- CRM3 for DC includes terminals for connecting a battery back-up system.
- Two-year UCS manufacturer's warranty. Requires reading FFI Installation Guide for applicable products before purchase, and confirmation of project and installation specs by licensed electrical contractor.
- This product is **not** UL Recognized; not recommended for commercial / institutional projects.

Recommendations for FFI Actuators & Controls: FFI only recommends UL compliant systems. FFI is a UL registered firm. Read FFI data sheets & installation guides before specifying project details. Project-specific needs vary depending on the number of actuators, electrical layouts, building management systems, distance between power supplies & actuators, and other details. Project specifications to comply with electric & building codes—for wire gauge, wire connections and run distance, conduits, junction boxes—must be arranged by the project electrical contractors. Distribute this guide to all project parties, including electrical contractors, architects, and building management personnel.

CRM Specifications

	CRM3 for DC actuators part # 40821J	CRM4 for AC actuators part # 40822K
Supply Voltage	115 Vac ± 10%, 60 Hz (line voltage)	115 Vac ± 10%, 60 Hz (line voltage)
Total output (all 4 groups)*	4 amps @ 24 Vdc	7 amps @ 115 Vac
Power Cable	2 wires (polarity inversion)	4 wires (Open, Close, Common, Ground)
Typical Switch	Keypad or Momentary contact	Keypad or Momentary contact
Safety Marks	CE rated, not UL-Recognized	CE rated, not UL-Recognized
Operating environment	14° to 140° F (-10° to 60° C)	14° to 140° F (-10° to 60° C)
Max. Relative Humidity	60%	60%
Case Dimensions	7-13/16" x 5-11/16" x 3-1/8"	7-13/16" x 5-11/16" x 3-1/8"

* FFI recommends do not exceed 80% of maximum amp capacity for control panels.

Optional Accessories for CRM Control Panels

Note: These accessories are CE Rated. They have not been UL Recognized (application pending).

Push-Button Keypad, part # 40770K (required for CRM)

Use "SELECT" button to choose a single group or all 4 groups. Then press OPEN or CLOSE. The Keypad includes an 8-channel infra-red detector for receiving signals from the Remote Control. Keypads can be connected in parallel. Dimensions 3" x 3" x 1-1/2".

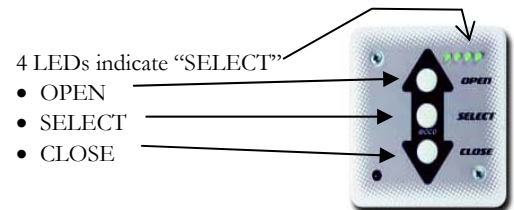

Remote Control, part # 40771L (optional)

The remote control signals the Keypad via line-of-sight, infra-red light signal on 1 of 8 selectable channels. Surface-mount wall clip included. Operating range approximately 30 feet. Requires two 1.5V AAA alkaline batteries (not included). **Remote must be used with Keypad.** Approx. Dimension: 4" x 1-13/16" x 1".



Wind Detector, part # 37185V (optional weather sensor)

The wind detector (anemomitor) sends a variable signal to Control Panel according to wind intensity. An 8-position selector in the Control Panel sets the wind threshold for closing windows. One wind sensor connects with up to **six** CRM Control Panels. Dimensions 4-1/2" x 4" x 4".



Thermostat, part # 40675K (optional weather sensor)

The thermostat has a single threshold setting. When ambient temperature rises above the threshold, the windows open. When temperature is below the threshold, the windows close. **The rain and wind sensors have priority over the thermostat.** One thermostat connects with up to **six** CRM Control Panels. Dimensions 3" x 3-1/4" x 1-1/2".



Rain Sensor, part # 40690A (optional weather sensor)

Senses rain and signals Control Panel to close windows. Heat element prevents ice. One rain sensor connects to up to **six** CRM Control Panels. Dimensions 1-1/2" x 2" x 2". **Rain sensor has priority over thermostat and wind sensor.**



Wall Switch, part # SW5657-2W

Momentary Contact Switch; use with CRM when connecting DC actuators to CRM3 JP7 terminal; see installation instructions. 15 amps max draw per switch. Dimensions 4" x 1-1/4" x 1-1/2".

