

Rapid-Block Spacers for WOOD

Rapid Spacers for Wood are adjustable spacers which allow the rapid and precise installation and adjustment of wooden window and door frames into rough openings.

Made of high quality synthetic resin, one spacer is inserted for each fixing screw in the frame. They have a threaded body with a built-in plastic adjustment screw, and come in four versions (see charts and diagrams on page 2). Drill bits for Rapid Spacers are available. Rapid Spacers can be inserted in a frame with equipment as simple as a drill and hammer, or with automated machinery, depending on production volume. Once in the field, they allow for very quick and precise installation within several minutes.

The installer can set the frame to plumb and level by simply turning the plastic adjustment screw of the spacers with a 5 mm hex key. A fixing screw is then inserted through the spacer, and tightened to secure the spacer (screws not included). Use screws of length to suit your installation (see diagrams for diameter on page 2). Future adjustments are easy and non-destructive.

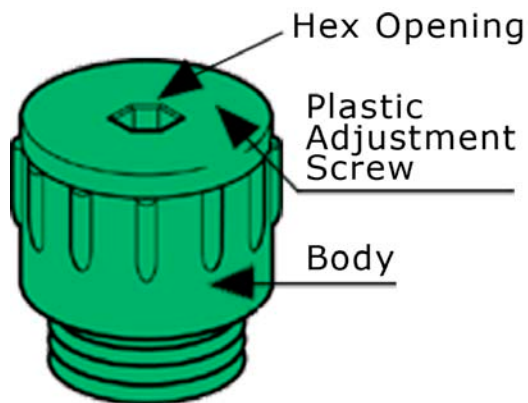

Why use one wood rapid spacer over another?

RB501 and **RB502** are the same except for the adjustment distance. **RB501** has an adjustment of 9mm and the **RB502** has 14mm, therefore the minimum frame thickness also is different. Because both **RB501** and **RB502** use a 5mm hex wrench, the diameter of the fixing screw could not exceed 5mm.

RB510 has an adjustment of 10mm and a smaller diameter body, and therefore might be used in narrower frames or even side by side on wide frames. **RB510** uses a 6mm hex wrench for adjustment, so the diameter of the fixing screw can be 6mm or smaller.

RB511 was designed for frame installation into masonry rough openings; it's the same as the **RB502** except an 8mm hex wrench is used for adjustment. This larger diameter allows for the insertion of an 8mm or smaller diameter masonry wall anchor and then a smaller diameter fixing screw for it.

Note: Dimensions are given in mm and not inches for precision with the manufacturer's specs.
(1" = 25.4 mm)

Minimum Frame Thickness for **RB501** and **RB510**: **25mm** (approx. 1")

Minimum Frame Thickness for **RB502** and **RB511**: **30mm** (approx. 1-3/16")

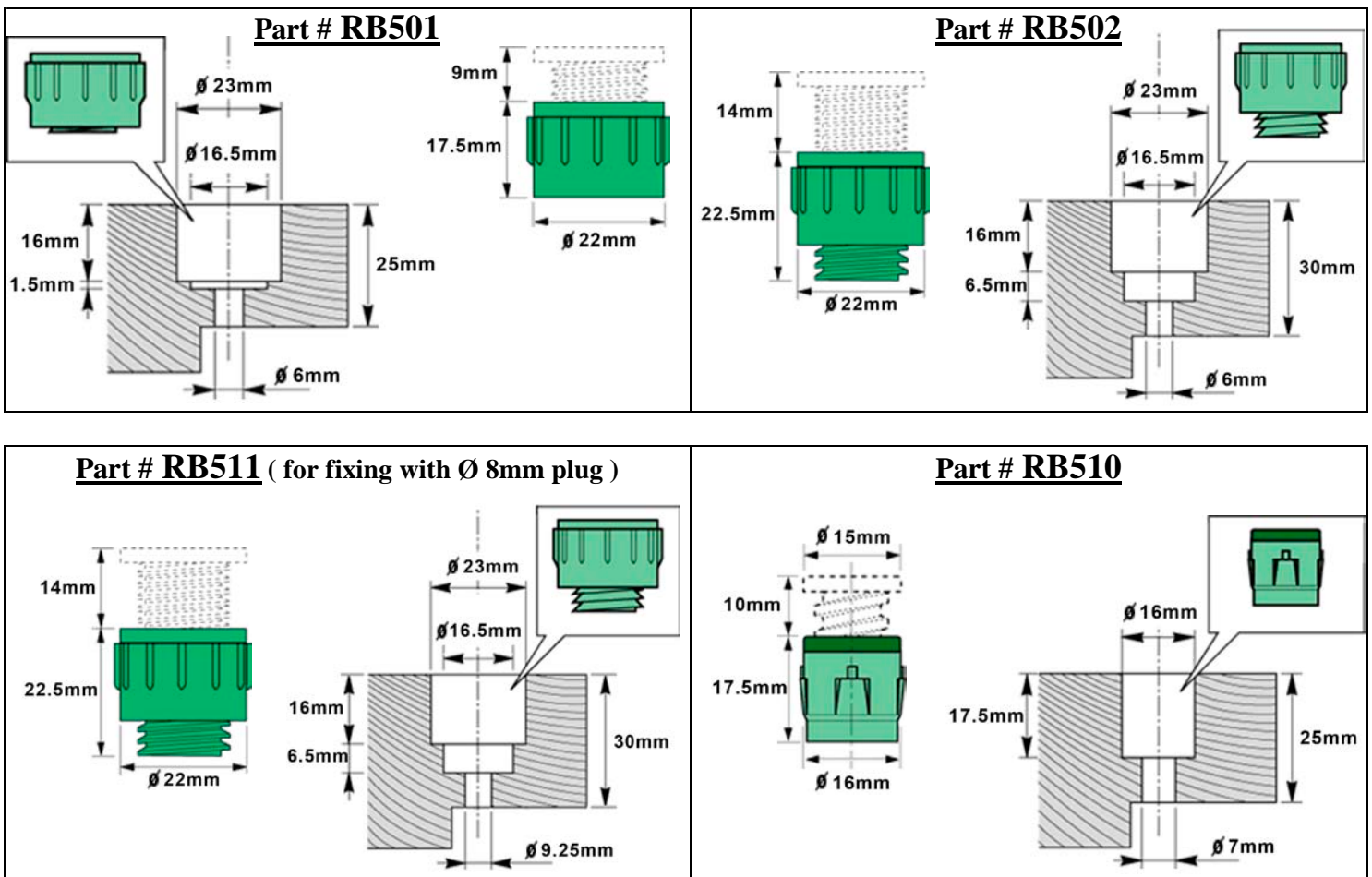

DOOR or WINDOW FITTING EXAMPLE

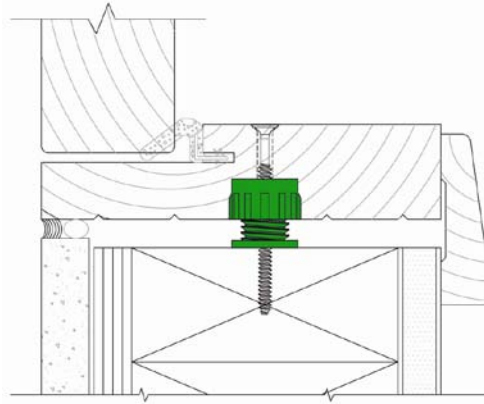

1. A countersunk hole for the spacer is drilled in the upright of the frame.

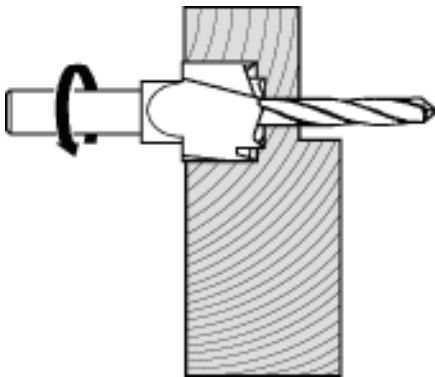

2. The Rapid Spacer is inserted into the frame.

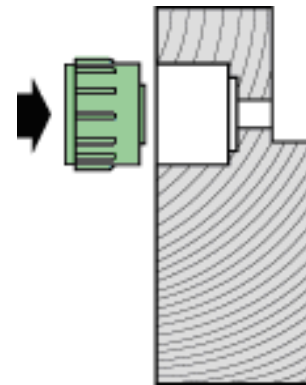

3. The space is adjusted and the window or door frames are aligned by turning the plastic adjustment screw with the hex key.

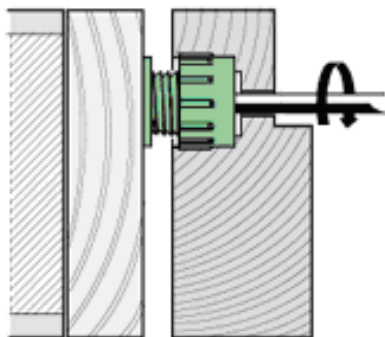

4. When positioned, the door or window frame is fixed with a screw of length.

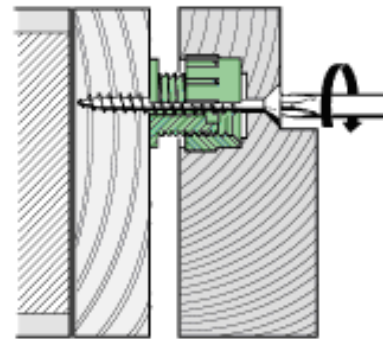

INSTALLATION TIPS for Rapid Spacers in Wood Frames:

1. Start with 2 Rapid Spacers on the bottom of the frame.
2. Then work your way up, placing one spacer on each side. For a typical window frame example, placing spacers at approximately 1/4 and 3/4 distance up the frame should be effective.
3. Spacers may not be necessary on top of the frame, and it should be considered that if the wall settles for example, it could cause unnecessary misalignment of the frame.
4. For aesthetic finishing, you may want to install wood caps or plugs (not included) to conceal the screws.

Optional DISTANCE PIECE for Rapid-Block Spacers for Wood

On rare occasions, it may be necessary to create a greater distance than normal. In this case, place one or more distance pieces, part # RB505, between the spacer and the trimmer. Using the special “handle” it is easy to fit the distance piece to the Rapid Spacer. Before tightening the fixing screw, turn the distance piece until the handle no longer protrudes from the frame.

Part #
RB505

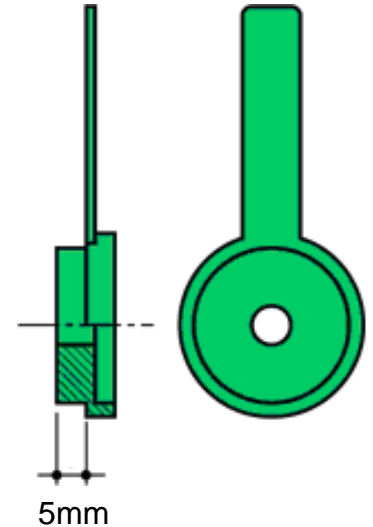
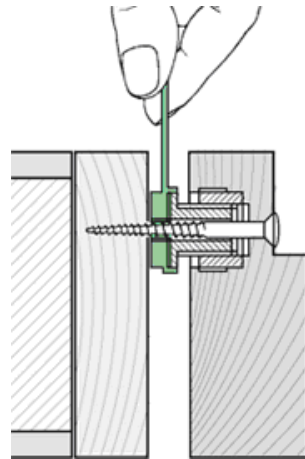

DRILL BITS for Rapid Spacers for Wood

Countersunk holes are drilled in the uprights of the window and door frames, using a basic drill bit (RP004 or RP005) connected to an interchangeable drill bit (RP006, RP007 or RP039) through the center, and locked by a threaded, internal hex stop screw. If Rapid Spacers are to be installed in doors or windows that already have a fastening hole, you can replace the interchangeable drill bit with a guide pin (RP008).

(dimensions in mm)

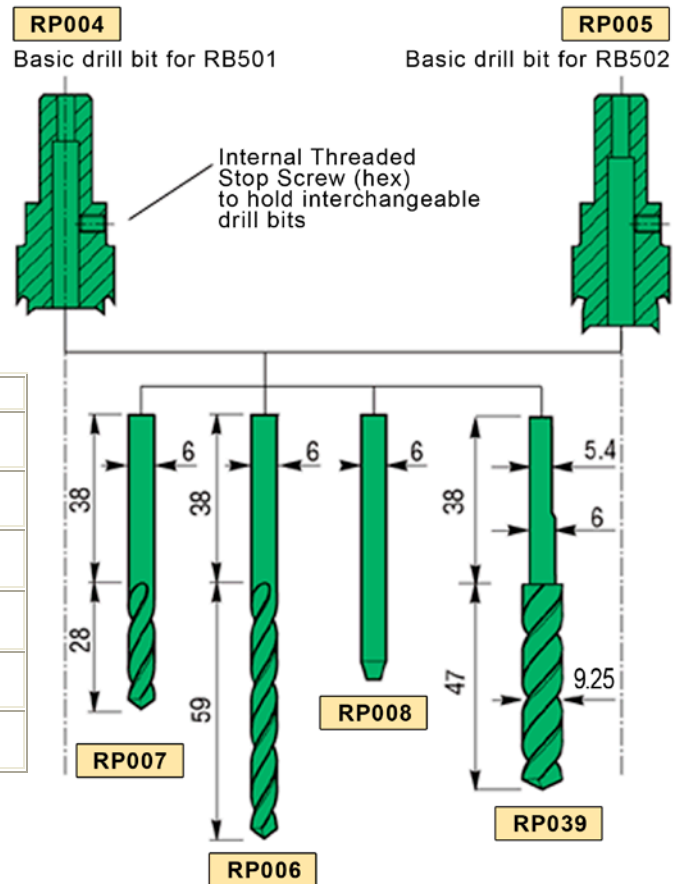

CODE	DESCRIPTION
RP004	Basic drill bit for Part# RB501
RP005	Basic drill bit for Part# RB502 or RB511
RP006	(For frames > 38 mm ≤ 62 mm) 6 mm diameter - long drill bit
RP007	(For frames ≤ 38 mm) 6 mm diameter – short drill bit
RP008	Guide pin – 6 mm diameter
RP039	9.25 mm diameter - short drill bit for Part# RB511

(note: for RB510, drill bits are not available.)

Hexagonal T- KEY

In zinc plated steel with nylon handgrip for the installation of Rapid Spacers.

PART #	Diameter "A" (see diagram)	Length "L" (see diagram)
RH004	5mm (approx. 3/16")	175mm (approx. 6-7/8")

Figure 1: dimensions

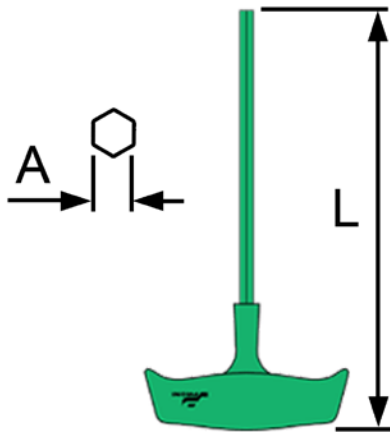
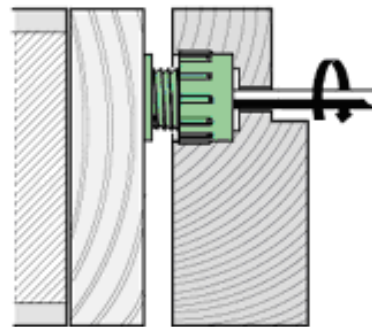

Figure 2: example



PARTS LIST

Order Code	Description	Unit	Box
Spacers for WOOD			
RB501	Rapid-Block Spacer	Pcs	2,000
RB502	Rapid-Block Spacer	Pcs	2,000
RB505	Distance Piece with Handle	Pcs	1,000
RB510	Rapid-Block Spacer	Pcs	2,000
RB511	Rapid-Block Spacer	Pcs	2,000
Hexagonal T-Keys			
RH004	5 mm Hexagonal T-key	Pcs	1
Drill bits			
RP004	Basic drill bit for RB501	Pcs	1
RP005	Basic drill bit for RB502 or RB511	Pcs	1
RP006	6 mm diameter - long drill bit	Pcs	1
RP007	6 mm diameter - short drill bit	Pcs	1
RP008	Guide pin – 6 mm diameter	Pcs	1
RP039	9.25 mm diameter drill bit (with 6 mm diameter shank) for RB511	Pcs	1
RP046	Rapid-Block Spacer Wood Kit	Pcs	1

Quality assurance: Rapid Spacers are manufactured by Proni in compliance with ISO 9001 standards. Warranty and testing standards are not specified by the manufacturer.

Contact FFI Customer Service for pricing or to place orders: 800-677-0228 or service@fenestration.net